

PORT OF SAN JOSE (DINAGAT ISLANDS)

Port Management Office of Surigao
Terminal Management Office of Dinagat

PORT PROFILE:

The Port of San Jose is the principal maritime gateway to the Island Province of Dinagat. It also serves as the seat of the Terminal Management Office of Dinagat which supervises ports in the island province. It is located at 10° 0'23.16"N latitude and 125°34'11.84"E.



Port of San Jose

San Jose, Dinagat Islands

PORT LOCATION:

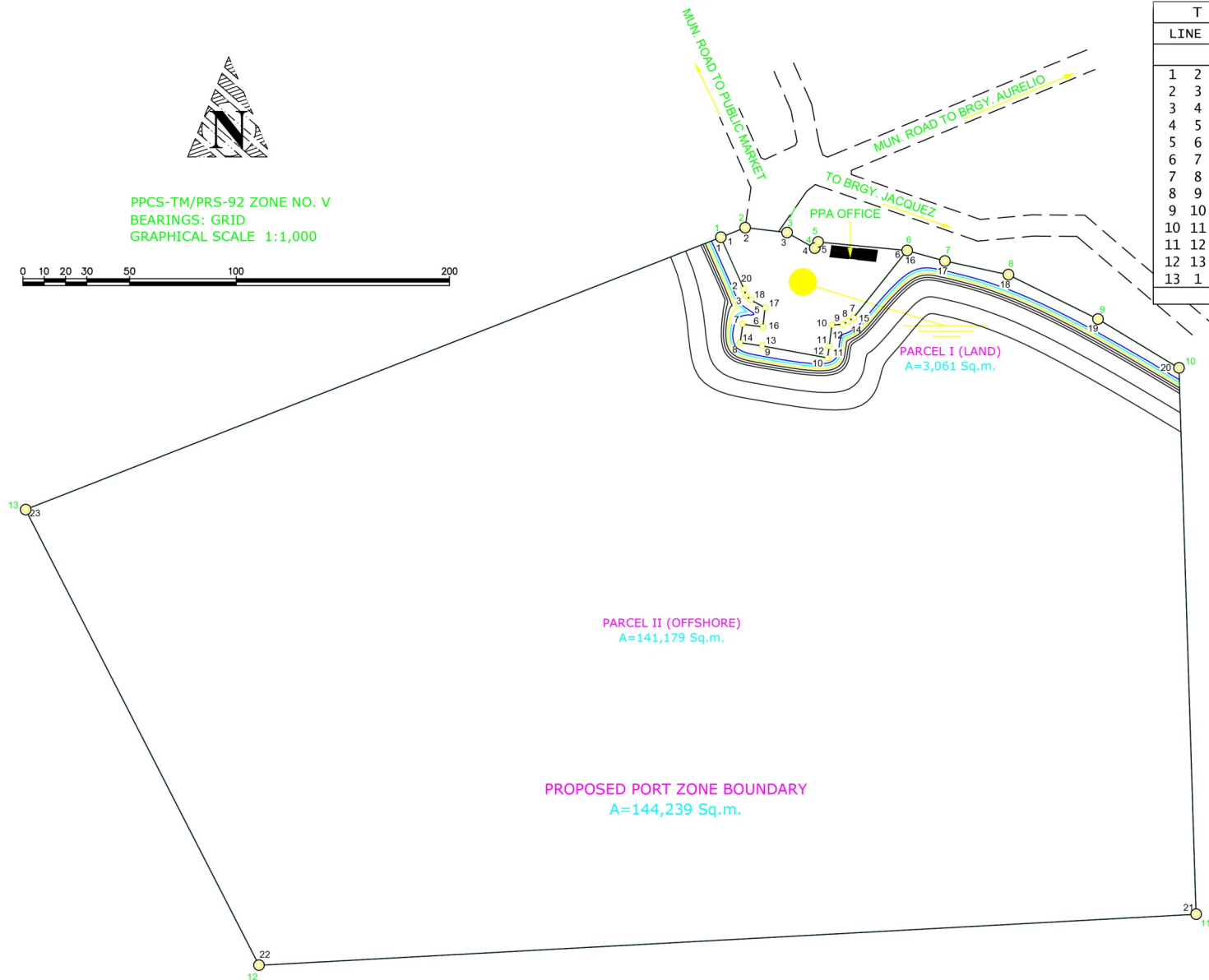

TECHNICAL DESCRIPTIONS					
LINE	BEARING	DISTANCE	LINE	BEARING	DISTANCE
BOUNDARY			PARCEL I (LAND)		
1 2	N 68°18' E	12.29 m.	1 2	N 68°18' E	12.29 m.
2 3	S 83°19' E	19.77 m.	2 3	S 83°19' E	19.77 m.
3 4	S 60°34' E	14.94 m.	3 4	S 60°34' E	14.94 m.
4 5	N 26°56' E	3.32 m.	4 5	N 26°56' E	3.32 m.
5 6	S 84°28' E	42.00 m.	5 6	S 84°28' E	42.00 m.
6 7	S 74°27' E	18.33 m.	6 7	S 38°34' W	40.22 m.
7 8	S 77°50' E	30.52 m.	7 8	S 54°57' W	3.05 m.
8 9	S 63°37' E	46.80 m.	8 9	S 63°08' W	3.02 m.
9 10	S 58°54' E	44.36 m.	9 10	S 85°41' W	5.03 m.
10 11	S 01°48' E	256.19 m.	10 11	S 07°14' W	10.10 m.
11 12	S 86°53' W	440.00 m.	11 12	S 07°45' W	5.44 m.
12 13	N 27°07' W	240.00 m.	12 13	N 79°33' W	31.25 m.
13 1	N 68°37' E	350.00 m.	13 14	N 81°50' W	10.37 m.
A=144,239 Sq.m.			14 15	N 08°10' E	8.70 m.
			15 16	S 82°38' E	9.48 m.
			16 17	N 06°51' E	9.07 m.
			17 18	N 61°07' W	7.52 m.
			18 19	N 49°11' W	3.05 m.
			19 20	N 18°18' W	3.25 m.
			20 1	N 24°10' W	26.62 m.
			A=3,061 Sq.m.		
PARCEL II (OFFSHORE)					
1 2	S 24°10' E	26.62 m.	1 2	S 24°10' E	26.62 m.
2 3	S 18°18' E	3.25 m.	2 3	S 18°18' E	3.25 m.
3 4	S 49°11' E	3.05 m.	3 4	S 49°11' E	3.05 m.
4 5	S 61°07' E	7.52 m.	4 5	S 61°07' E	7.52 m.
5 6	S 06°51' W	9.07 m.	5 6	S 06°51' W	9.07 m.
6 7	N 82°38' W	9.48 m.	6 7	N 82°38' W	9.48 m.
7 8	S 08°10' W	8.70 m.	7 8	S 08°10' W	8.70 m.
8 9	S 81°50' E	10.37 m.	8 9	S 81°50' E	10.37 m.
9 10	S 79°33' E	31.25 m.	9 10	S 79°33' E	31.25 m.
10 11	N 07°45' E	5.44 m.	10 11	N 07°45' E	5.44 m.
11 12	N 07°14' E	10.10 m.	11 12	N 07°14' E	10.10 m.
12 13	N 85°41' E	5.03 m.	12 13	N 85°41' E	5.03 m.
13 14	N 63°08' E	3.02 m.	13 14	N 63°08' E	3.02 m.
14 15	N 54°57' E	3.05 m.	14 15	N 54°57' E	3.05 m.
15 16	N 38°34' E	40.22 m.	15 16	N 38°34' E	40.22 m.
16 17	S 74°27' E	18.33 m.	16 17	S 74°27' E	18.33 m.
17 18	S 77°50' E	30.52 m.	17 18	S 77°50' E	30.52 m.
18 19	S 63°37' E	46.80 m.	18 19	S 63°37' E	46.80 m.
19 20	S 58°54' E	44.36 m.	19 20	S 58°54' E	44.36 m.
20 21	S 01°48' E	256.19 m.	20 21	S 01°48' E	256.19 m.
21 22	S 86°53' W	440.00 m.	21 22	S 86°53' W	440.00 m.
22 23	N 27°07' W	240.00 m.	22 23	N 27°07' W	240.00 m.
23 1	N 68°37' E	350.00 m.	23 1	N 68°37' E	350.00 m.
			A=141,179 Sq.m.		
TIE LINES from SRN 30 NAMRIA to corner "1":					
LOT	BEARING	DISTANCE			
PZD BOUNDARY	S 48°38' W	3003.03 m.			
PARCEL I (LAND)	S 48°38' W	3003.03 m.			
PARCEL II (OFFSHORE)	S 48°38' W	3003.03 m.			

B. Total Port Area: 4,261 square meters

C. Sea Distance: Around 10 meters from the TMO Dinagat Building to the harbor waters

D. Land Access: Main gate is connected by Pescadores Street (leading to market) and DM Avenue (going uptown)

E. Entrance Channel: Surigao Strait leading towards Melgar Bay

F. Physical Environment:

Topography and Oceanography:

Dinagat Island is a northern extension of the mountains of Mindanao, forming an island separate from the remainder of Mindanao and is thought to have formed as a part of a land bridge between Northern Mindanao and Eastern Visayas (Leyte, Samar, and Bohol) and is the third largest Island in Mindanao. The island is considered one of the areas in the Philippines characterized as ultramafic outcrops together with Palawan, Samar, Zambales, Zamboanga, Mindoro, and Sulu. It is rich in chromite deposits similar to Zambales and Palawan while Alluvial platinum-group minerals have been panned also in Dinagat Island, together with Samar.

Meteorology and Climate:

Dinagat Islands is less frequented by typhoons as shown in the climate map of the Philippines of PAG-ASA, Weather Bureau. But the province is often as a reference point for tropical disturbances entering the country. It has a type II climate characterized by no pronounced dry season with a very pronounced maximum rain period from November to January.

Seismic Conditions:

The Dinagat Islands is located in between the Philippine Fault on the west and the Philippine Trench on the east. According to the geologic map of the United Nations Revolving Fund for Natural Resources Exploration (UNRFNRE), major faults in Dinagat Island is observed to be uniformly NW trending having complimentary NE trending faults. Some of these NE trending structures are lineaments and shear zones.

PORT FACILITIES

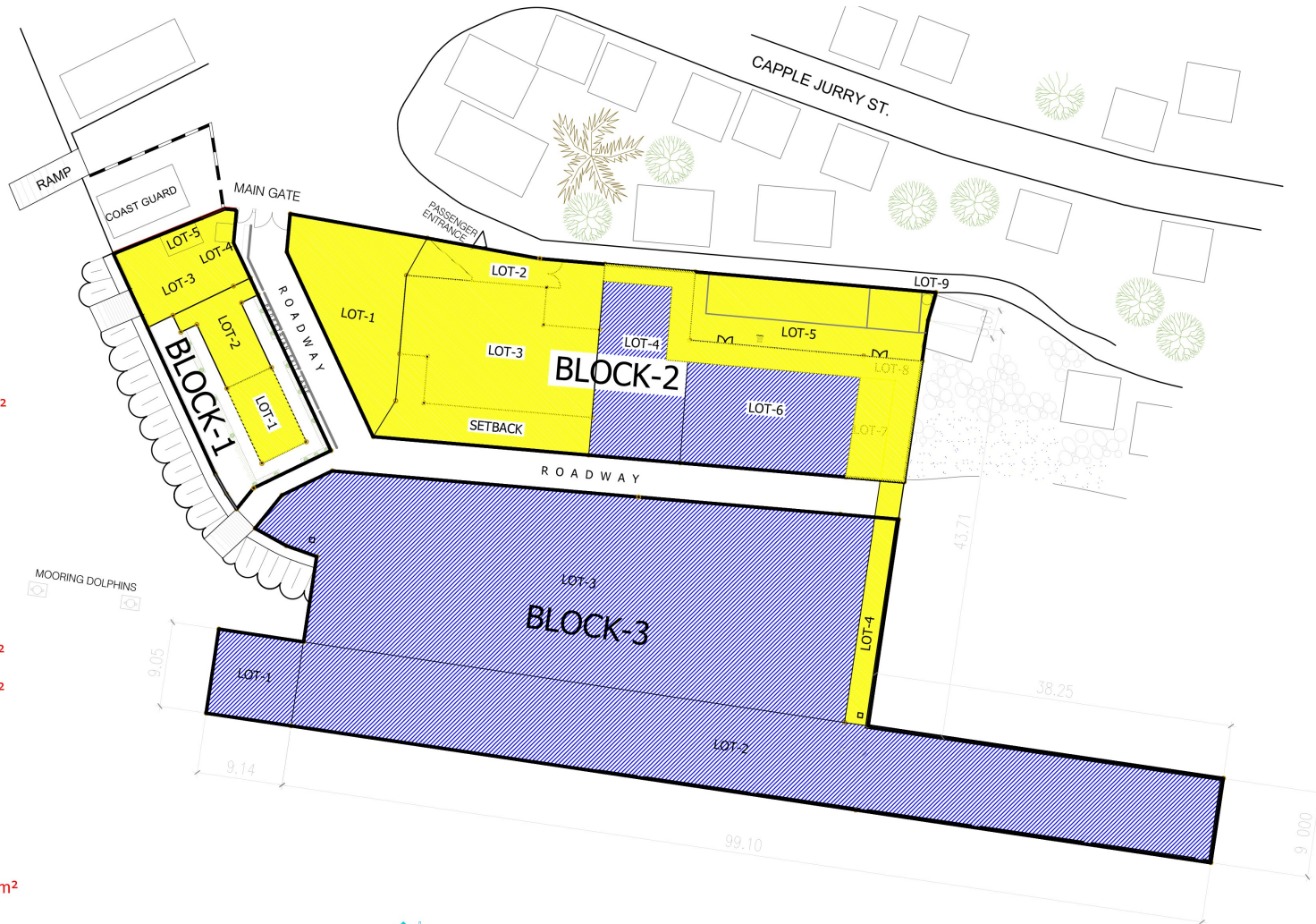
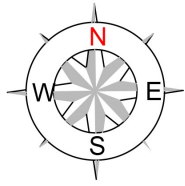

BLOCK-1

Total Land Area = 352.55m²

- LOT-1: Cargo Shed = 46.19m²
- LOT-2: Cargo Handling Office = 66m²
- LOT-3: Open Area for Lease = 88.16m²
Setback total Area = 138.35m²
- LOT-4: Guard House = 4m²
- LOT-5: Power House = 9.85m²

BLOCK-2

Total Land Area = 1,326.70m²

- LOT-1: Parking Area = 186.04m²
- LOT-2: Ticketing Booth = 91.66m²
- LOT-3: PTB = 346.65m²
Building = 242.40m²
Setback total Area = 104.25m²
- LOT-4: Open Storage Area = 162.46m²
- LOT-5: TMO Bldg./Qtrs. = 181.81m²
- LOT-6: Open Storage Area = 194.74m²
- LOT-7: Parking Area = 39.70m²
- LOT-8: Covered Walkway = 119.64m²
- LOT-9: Elevated Water Tank = 4m²

BLOCK-3

Total Land Area = 2,254.07m²

- LOT-1: RO-RO Ramp = 81m²
- LOT-2: Apron = 897.33m²
- LOT-3: Open Storage Area = 1,219.51m²
- LOT-4: Covered Walkway = 56.23m²



Total Area of all Blocks = 3,933.32m²

Total Area of Roadway = 327.68m²

Total Land Area = 4,261.00m²

 **PORT LAYOUT PLAN**
SCALE 1:500 M

Legend:

-  Operations Area
-  Commercial/Support Facility

PORT SERVICES

I. Vessel Services:

- A. Pilotage: Surigao Harbor Pilots Association
- C. Line Handling: Doming Arrastre and Stevedoring
- D. Mooring/Unmooring: Doming Arrastre and Stevedoring

II. Cargo Services Provider: Doming Arrastre and Stevedoring

Services Offered:

- A. Cargo Checking
- B. Cargo Surveying
- C. Open Storage Area : 194.64 square meters

III. Passenger Terminal Building: 346.65 square meters.



REGISTERED PRIVATE PORTS UNDER THE TERMINAL MANAGEMENT OFFICE OF DINAGAT

NAME OF PORT FACILITY & LOCATION	OWNER/OPERATOR	FACILITIES	Main Functions of the Private Port	Nature of Business/ Commodities Handled
1 CAGDIANAO MINING CORPORATION, Brgy. Valencia, Cagdianao, Dinagat Province	CAGDIANAO MINING CORPORATION	20m x 100m Causeway/Pier, 10m dia. x 7.20m Fuel Depot, 100m dia. x 180m Fuel Supply Pipeline, 300mm x 1.50m Mooring Post	Loading/Unloading Facility for Deck Cargo (LCT-Type) Ships	Nickel Ore
2 SINOSTEEL PHILIPPINES H.Y. MINING CORPORATION, Brgy. Esperanza, Loreto, Dinagat Province	SINOSTEEL PHILIPPINES H.Y. MINING CORPORATION	100m x 18m Causeway/Pier	Loading/Unloading Facility for Deck Cargo (LCT-Type) Ships	Nickel Ore
3 LIBJO MINING CORPORATION, Sitio Balite, Brgy. San Antonio, Libjo, Dinagat Province	LIBJO MINING CORPORATION	12m x 130m Causeway	Loading/Unloading Facility for Deck Cargo (LCT-Type) Ships	Nickel Ore



VESSEL'S DAILY TRIP SCHEDULE

San Jose, Dinagat Islands to Surigao City

TRIP NO.	DEPARTURE		VESSEL	ARRIVAL		REMARKS
	Time	Origin	Vessel Name	Time	Destination	
1	5:30 am	Port of San Jose	M/V CAB-ILAN	7:30 am	Port of Surigao	NO TRIP EVERY SUNDAY
2	6:00 am	Port of San Jose	M/V VIEL'S LINER-2	7:00 am	Port of Surigao	
3	6:30 am	Port of San Jose	M/V NEWS MPC ISLANDS NAVIGATOR 3	7:30 am	Port of Surigao	
4	8:30 am	Port of San Jose	M/V VINCE GABRIEL -2	9:30 am	Port of Surigao	
6	9:30 am	Port of San Jose	M/V VIEL'S LINER-2	10:30 am	Port of Surigao	
7	10:00 am	Port of San Jose	M/V MARIE KRISTINA	12:00 NN	Port of Surigao	
8	11:30 am	Port of San Jose	M/V NEWS MPC ISLANDS NAVIGATOR 3	12:30 NN	Port of Surigao	
9	1:30 pm	Port of San Jose	M/V VIEL'S LINER-2	2:15 pm	Port of Surigao	
10	2:45 pm	Port of San Jose	M/V VIEL'S LINER-2	3:45 pm	Port of Surigao	
12	4:30 pm	Port of San Jose	M/V VINCE GABRIEL -2	5:30 pm	Port of Surigao	
13	5:00 pm	Port of San Jose	M/V MARIE KRISTINA	7:00 pm	Port of Surigao	
14	5:30 pm	Port of San Jose	M/V NEWS MPC ISLANDS NAVIGATOR 3	6:30 pm	Port of Surigao	
15	6:15 pm	Port of San Jose	M/V VIEL'S LINER-2	7:15 pm	Port of Surigao	

Surigao City to San Jose, Dinagat Islands

TRIP NO.	DEPARTURE		VESSEL	ARRIVAL		REMARKS
	Time	Origin	Vessel Name	Time	Destination	
1	4:00 am	Port of Surigao	M/V MARIE KRISTINA	6:00 am	Port of San Jose	NO TRIP EVERY SUNDAY
2	5:30 am	Port of Surigao	M/V VINCE GABRIEL -2	6:30 am	Port of San Jose	
3	7:00 am	Port of Surigao	M/V VIEL'S LINER-2	8:00 am	Port of San Jose	
4	9:30 am	Port of Surigao	M/V NEWS MPC ISLANDS NAVIGATOR 3	10:30 am	Port of San Jose	
6	10:30 am	Port of Surigao	M/V VIEL'S LINER-2	11:30 am	Port of San Jose	
7	12:00 NN	Port of Surigao	M/V CAB-ILAN	2:30 pm	Port of San Jose	
8	12:30 NN	Port of Surigao	M/V VIEL'S LINER-2	1:30 pm	Port of San Jose	
9	1:30 pm	Port of Surigao	M/V VINCE GABRIEL -2	2:30 pm	Port of San Jose	
10	2:00 pm	Port of Surigao	M/V MARIE KRISTINA	4:00 pm	Port of San Jose	
12	3:00 pm	Port of Surigao	M/V NEWS MPC ISLANDS NAVIGATOR 3	04:00PM	Port of San Jose	